



Daikin *One* Lite Connected Thermostat Installation & Commissioning



Disclaimer

This material provides technical information that is to only be used by appropriately trained and certified HVAC-R installers and technicians who have agreed to the terms and conditions available here at <https://www.daikincity.com/DaikinCityB2BTermsOfUse.html>. If you have not agreed to these terms and conditions, you may not use or view this material, and you assume responsibility for any injury or property, system or equipment damage which may result. If you have agreed to these terms, you also agree, by viewing or using this material, that this material, by its nature, cannot include a discussion of everything necessary to effect a proper installation or repair of HVAC-R equipment, nor can it address every possible scenario or environment a technician or installer may encounter. Accordingly, this material should not be considered as recommendations for best practices and will not be considered installation or repair instructions to the extent of any conflict with Daikin- or Goodman-issued manuals and specifications, or industry standards and regulations. Each installer or technician remains fully responsible for ensuring proper installation or repair of the HVAC-R equipment being worked on, and you remain fully responsible for any injury or property, system or equipment damage which may result from your installation. ©2023 Daikin Comfort Technologies North America, Inc., all rights reserved; recording, copying, or distribution of this material is prohibited without express written permission from Daikin.

Agenda

Daikin *One* Lite

System Configurations



Installing Daikin *One* Lite

Daikin *One* Cloud Services

Commissioning Daikin *One* Lite

Daikin *One* Home

Daikin One Lite

- Affordable solution for ductless products.
- Small footprint design.
- Commissioning and setup can be accomplished with the Daikin *One* Cloud Services app.
 - The end user will be able to control the system remotely through the Daikin *One* Home app.
 - Additional option for commissioning is through the Daikin *One* Lite user interface.
 - **Limited features.**
- Compatible with Amazon  and  Google Home
- Open API for integration into most home control systems, such as Crestron® and Control4®.



Daikin One Lite Interface

- Pressing or holding down a button or combination of buttons navigates the user through menus to view/adjust settings.



- Navigation through menus and adjusting can also be made using tactile gestures on the Daikin One Cloud Services and Daikin One Home applications from your mobile device.





- Daikin One's messaging updates, confirms, and informs about selections you make during set-up and operation.
- There are four types of messages:
 - Status
 - Blue-cooling
 - Red- heating
 - Alerts
 - A critical alert is displayed as a message until resolved by the dealer and dismissed by putting the unit in "OFF" mode and then back into an operation mode.
 - Reminders and Prompts
 - Learn more/tips (App. Only)

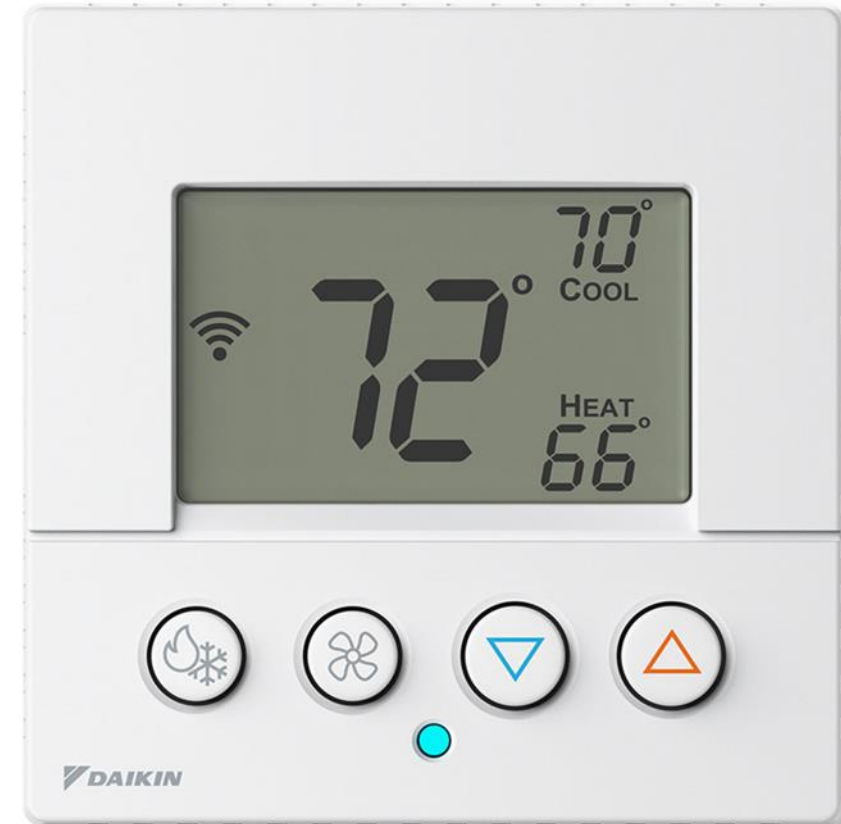

Daikin One Lite Packaging

Quick reference cards are packaged with the thermostat to help answer questions during the installation and commissioning.

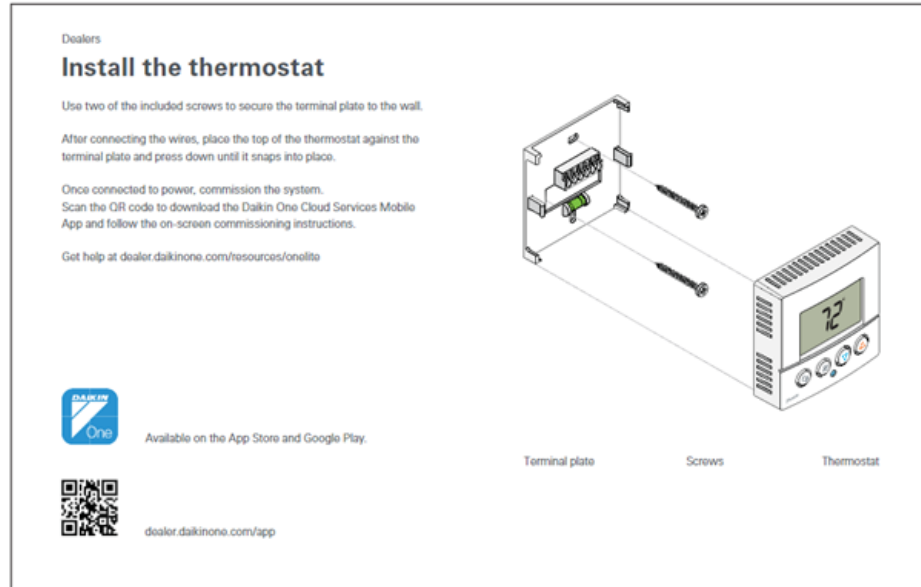

- **Scanning** the bar code on the **bottom left** corner will link you to a website related to the title of the card.

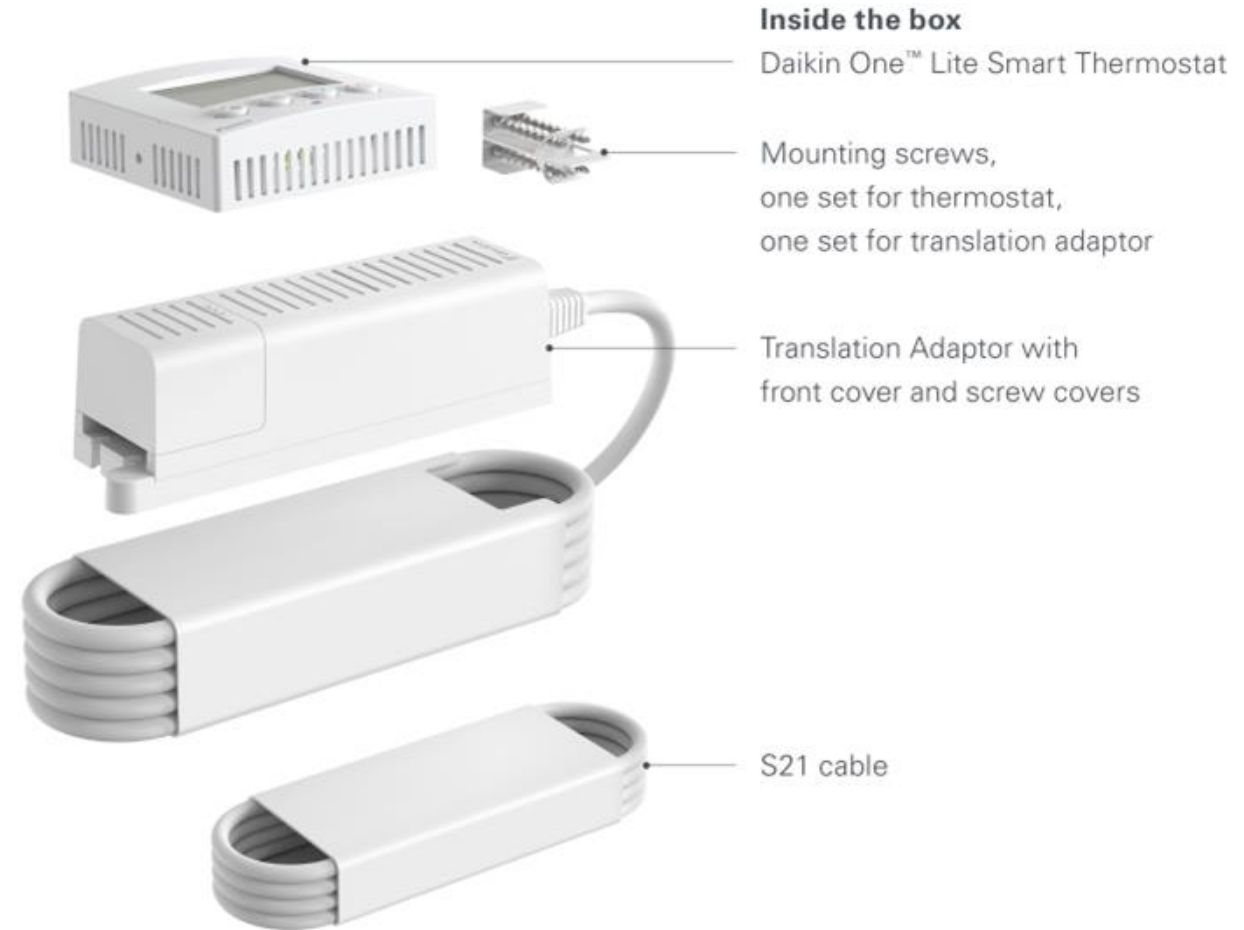

Agenda

Daikin *One* Lite

System Configurations

Installing Daikin *One* Lite

Daikin *One* Cloud Services

Commissioning Daikin *One* Lite

Daikin *One* Home



Indoor units that have S21 Interface

Indoor units that do not have S21 Interface

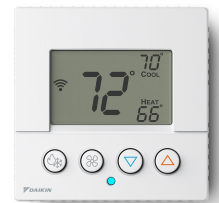

Notes: the Daikin One Lite is not compatible with:
handheld IR remote controller – BRC944 – KRP928

Indoor Unit Models (require interface adaptor)	Required Interface Adaptor
FTXM09-24VVJU, FTXM9-24WVJU9	KER087A41
FTX09NMVJU(A), FTX12NMVJU(A), FTX09WMVJU9, FTX12WMVJU9	KRP067A41E
FTX15NMVJU(A), FTX15WMVJU9	KRP980B2E



Agenda

Daikin *One* Lite
System Configurations

Installing Daikin *One* Lite

Daikin *One* Cloud Services

Commissioning Daikin *One* Lite

Daikin *One* Home App.



DO NOT install the thermostat where it can be affected by:

- Drafts or dead spots behind doors and in corners.
- Hot or cold air from ducts or ceiling fans.
- Radiant heat from the sun or appliances.
- Concealed pipes and chimneys.
- Unheated (uncooled) areas such as an outside wall.



Installing Daikin *One* Lite Thermostat



- Mount the thermostat to be
 - Leveled.
 - Approximately 5' from the floor.
 - On an interior wall using the included screws.

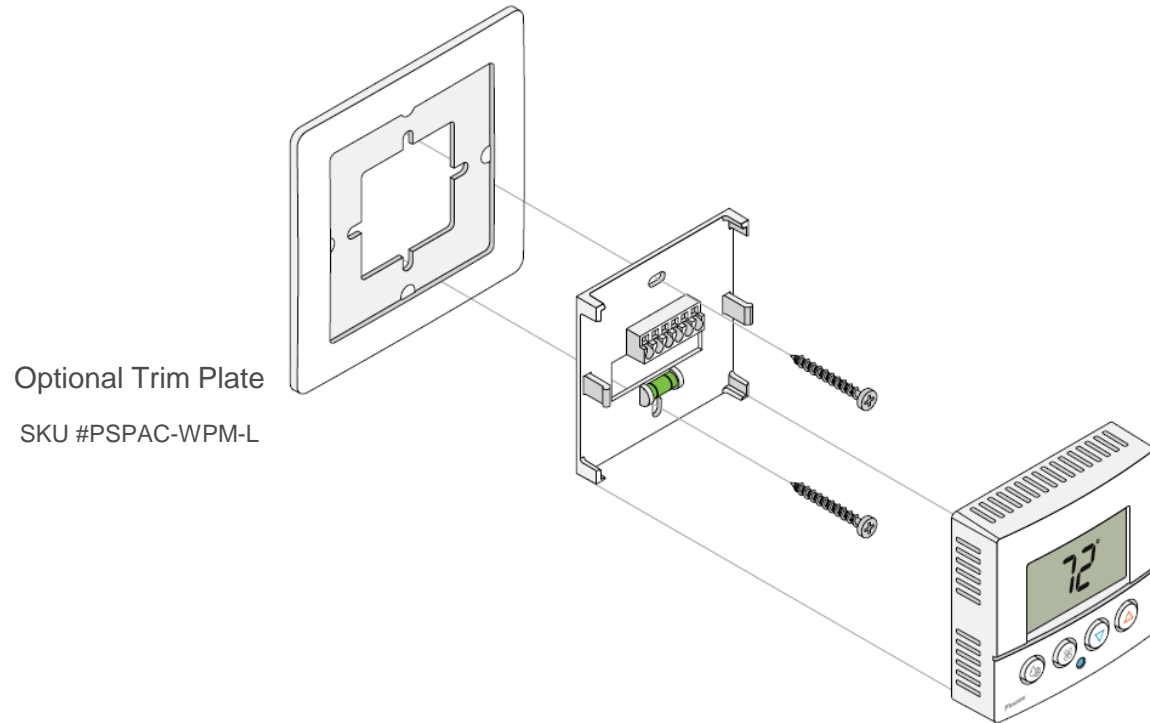

Optional Trim Plate
SKU #PSPAC-WPM-L



FLOOR



- Maximum wire distance between the Daikin *One* Lite and the translation adaptor should not exceed **125 feet using four conductor 18-gauge field supplied wire.**
- Seal the hole made for routing the wiring to the thermostat's terminal subbase.
- **Check for proper voltage before and after wiring is installed.**
 - 0.6 - 0.9VDC between Data 1 and 2
 - 24VAC between R and C
 - Line voltage 230VAC

Note: If wired incorrectly, you will receive an error.

- If power wires are reversed the PWR LED will flash green.

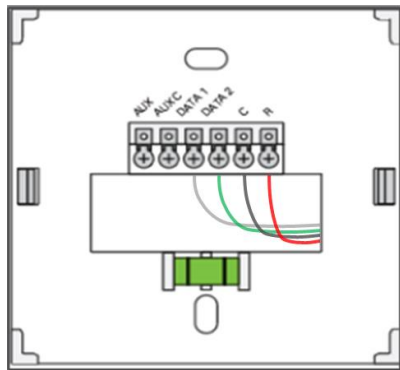

Aux to Aux C is a 24V AC Dry contact.

- ① Data Line 1
- ② Data Line 2
- Ⓒ 24 volt common
- Ⓓ 24 volt power



Translation Adaptor Detail

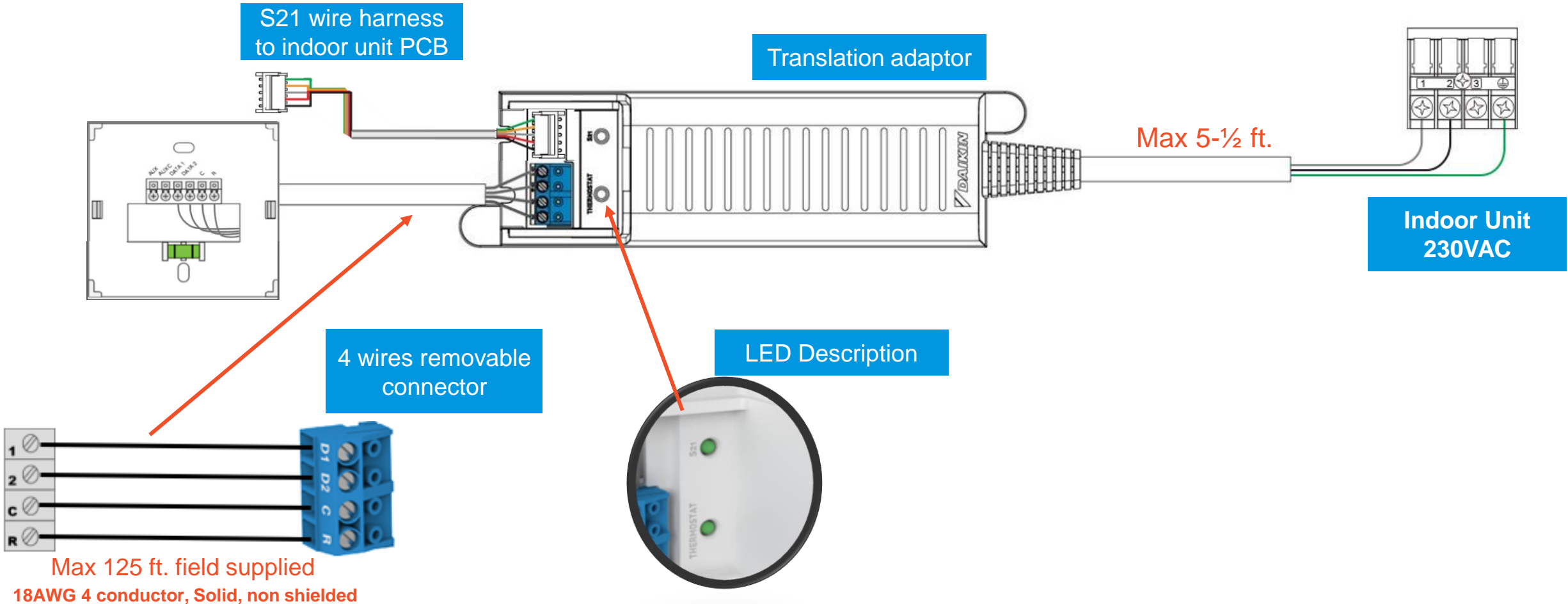

Mounting the Translation Adaptor



- Mount using screws.
 - Never use screws to mount to an indoor unit.
- Two channels on the backside of the adaptor allow the S21 and thermostat cables to exit the same side of the adaptor.

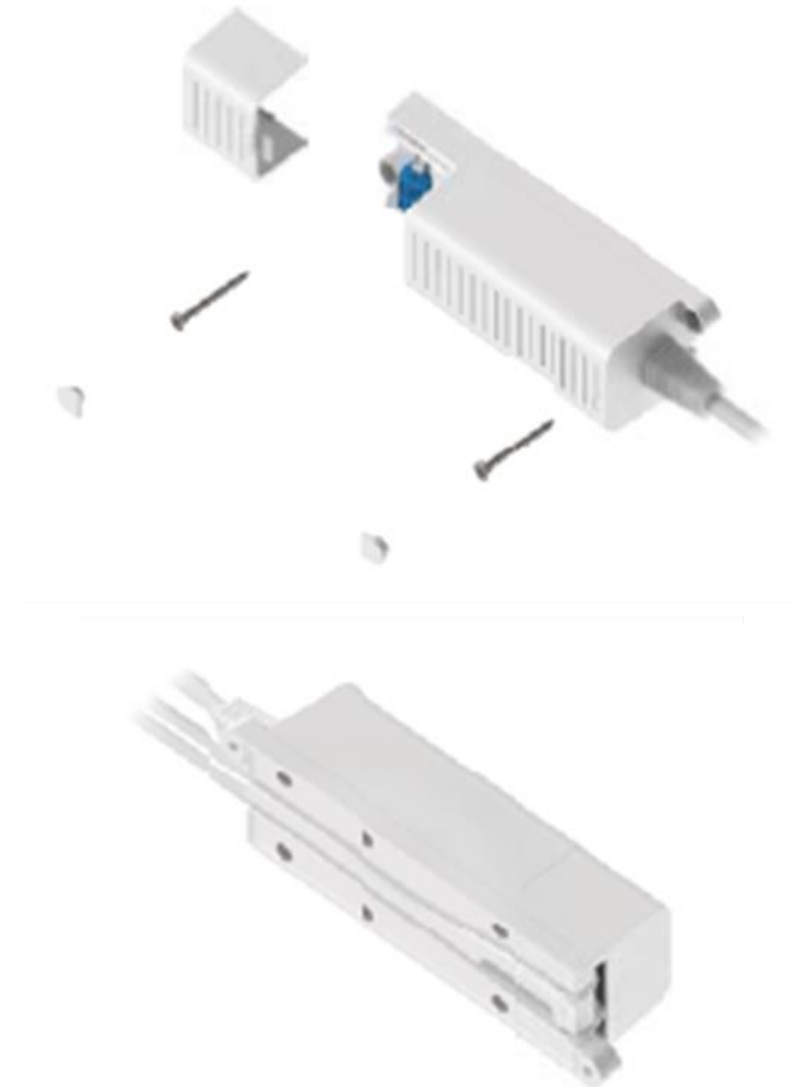

Translation Adaptor Location and Considerations

Wall mounted indoor unit

- If spacing allows, the translation adaptor can be mounted inside the piping chase. Otherwise, it can be mounted on the outside of the indoor unit.

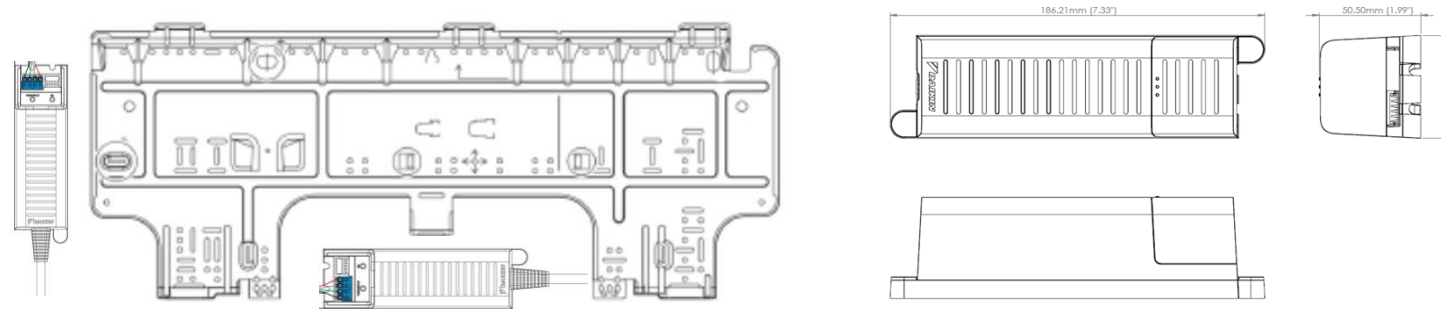

Ducted indoor unit

- Translation adaptor can be mounted on the side and top of the indoor unit, or above the ceiling using field-supplied double-sided adhesive tape.



Agenda

Daikin *One* Lite

System Configurations

Installing Daikin *One* Lite

Daikin *One* Cloud Services

Commissioning Daikin *One* Lite

Daikin *One* Home



- In order to save profiles created utilizing the cloud service tool, you must be a member of an active Cloud Services account.
 - An email invitation to join Cloud Services will need to be accepted.

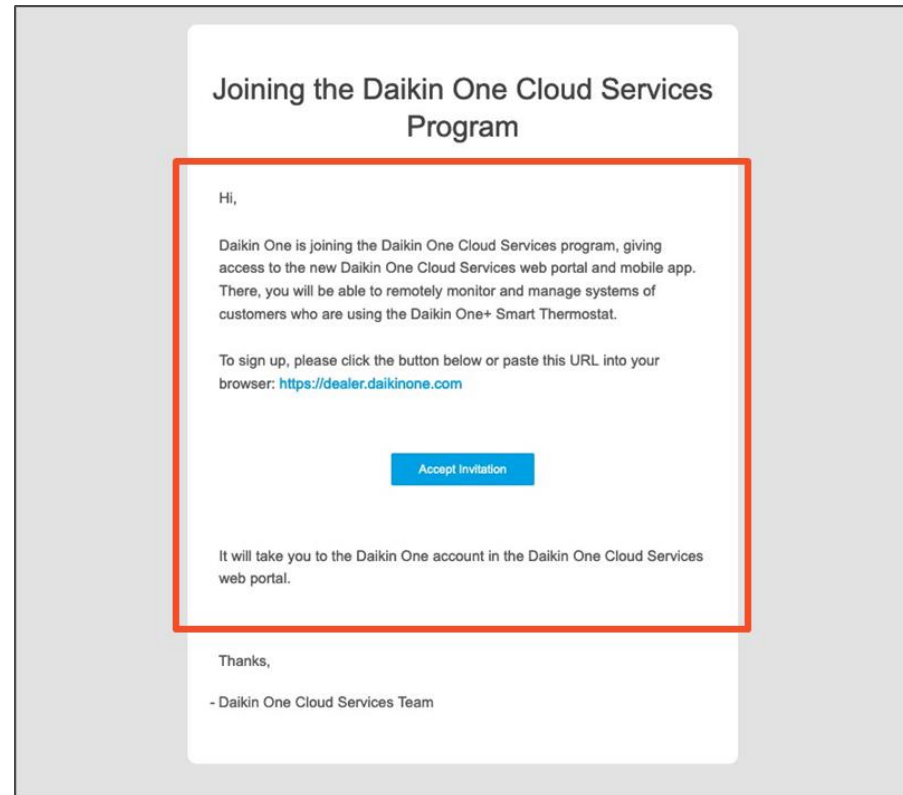

Daikin *One* Lite can be commissioned using the Daikin *One* Cloud Services app without an account activated.

Create Daikin One Cloud Services Account (Dealer Employee)

1. When the employee clicks “Accept Invite” in the email they will be directed to <https://dealer.daikinone.com>, where they will click “Sign in with Daikin”.
2. They will be directed to a login page, where they will click “Sign up now” below the “Sign In” button.

1

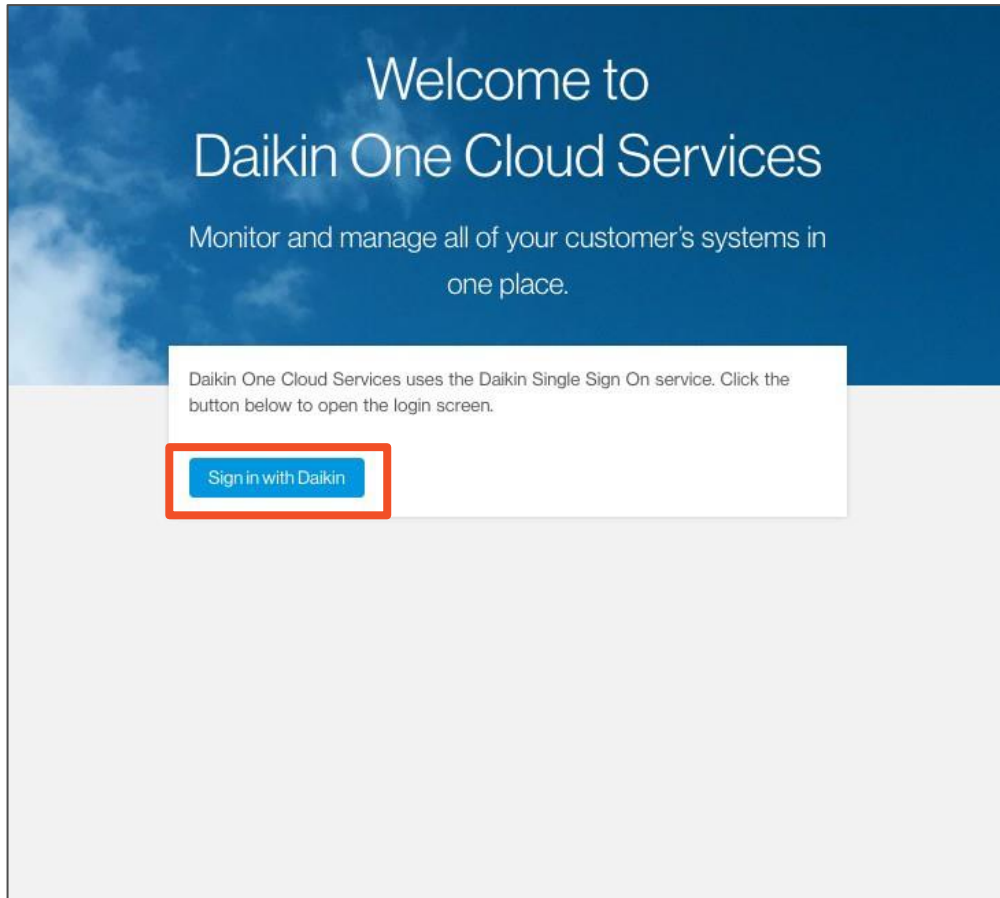

2

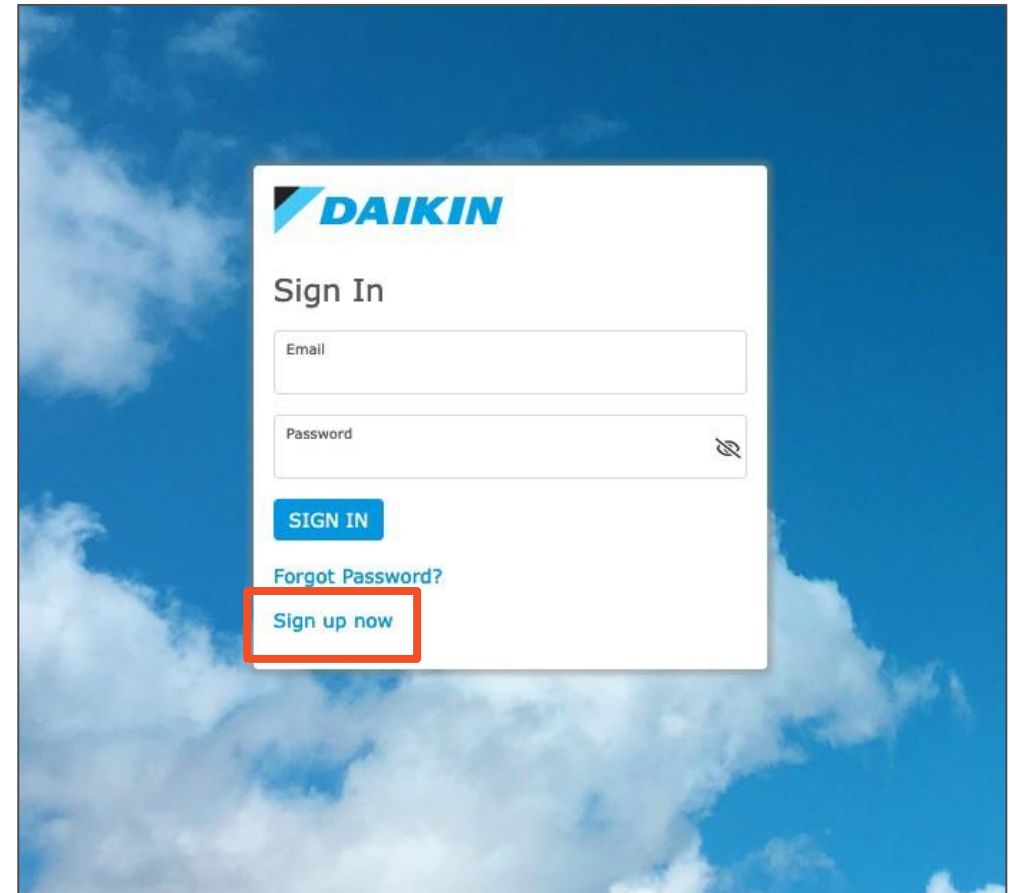

Create Daikin One Cloud Services Account (Dealer Employee)

3. The employee will be prompted to create a user login tied to the email used to invite them.
 - Complete all fields and ensure password meets criteria.
4. Employee will accept the Terms of Use and Privacy Policy, and then click “Register”.

3

✓ At least 8 characters in length
Contains at least 3 of the following 4 types of characters

- ✓ Lower case letters (a-z)
- ✓ Upper case letters (A-Z)
- ✓ Numbers (i.e. 0-9)
- ✓ Special characters (e.g. !@#%&*)

Password *

Verify Password *

First Name *

Last Name *

I have read and accept the Terms of Use, the Privacy Policy, and the B2B Account Terms of Use.

REGISTER

[Back to login](#)

4

DAIKIN

Email *

refrigerant.ralph@gmail.com

Password *

Verify Password *

First Name *

Ralph

Last Name *

Refrigerant

I have read and accept the Terms of Use, the Privacy Policy, and the B2B Account Terms of Use.

REGISTER

[Back to login](#)

Create Daikin *One* Cloud Services Account (Dealer Employee)

5. The employee will receive confirmation that their account was created successfully and needs to check their email for the verification email.
6. The employee will open the email with the subject “Daikin *One* Cloud Services: Verify your email” and click “Verify your account”.

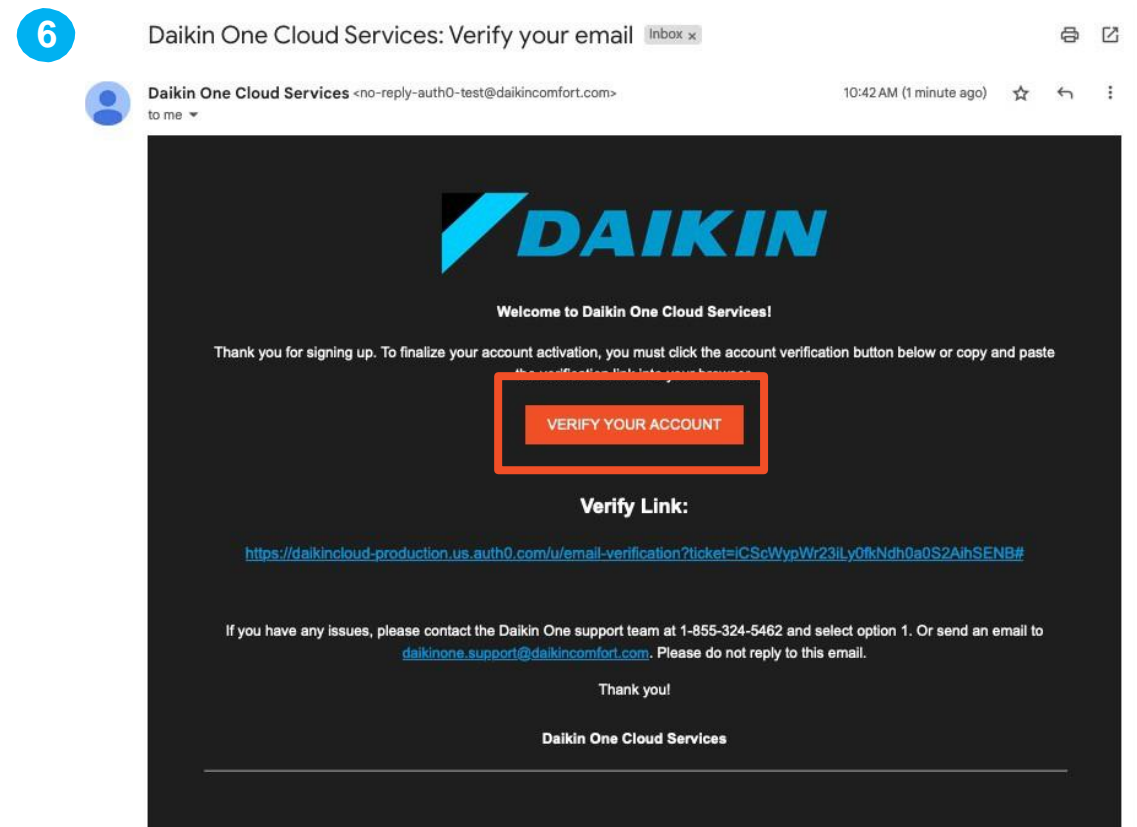
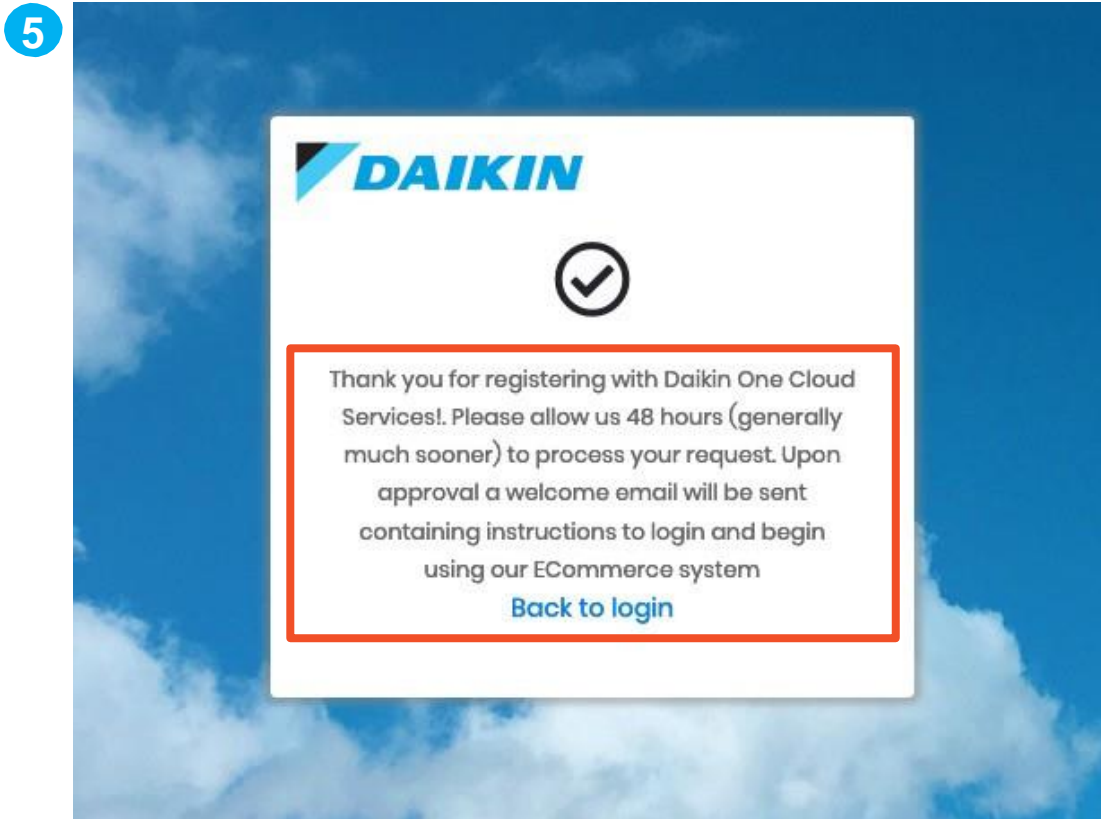

Create Daikin *One* Cloud Services Account (Dealer Employee)

7. The web page will provide confirmation that the email has been verified and the employee account has been created.
8. Employee will then return to <https://dealer.daikinone.com> and enter their newly created account credentials.

7

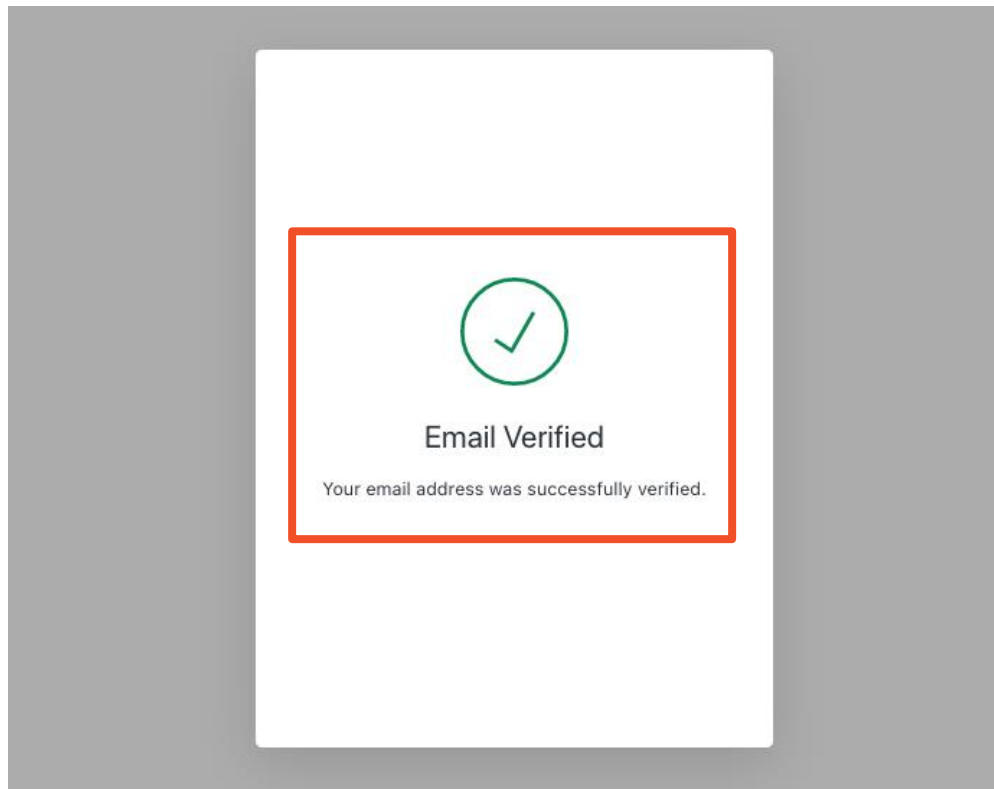

8

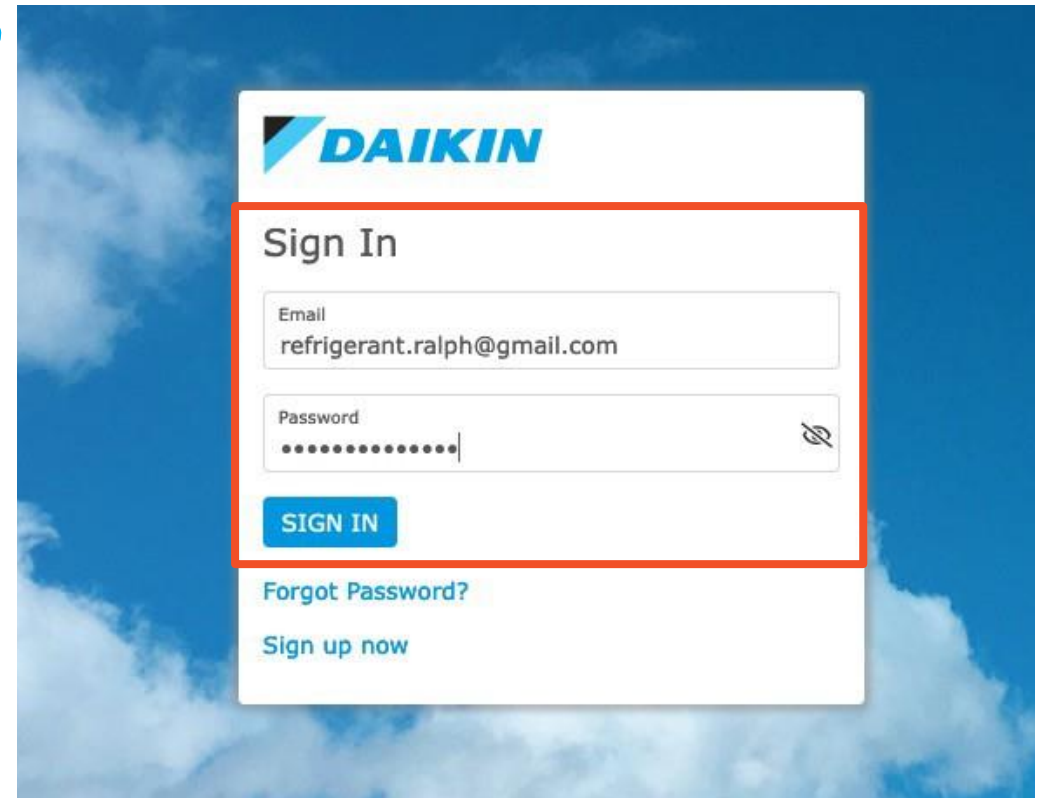

Daikin One Cloud Services: Initial Login

9. Upon your login, new users are directed to the “What’s New!” page which highlights recent feature releases, news, and updates.
10. The employee can navigate into Cloud Service by clicking on the *Dashboard*, *Customers*, or *Map* navigation icons on the left-hand navigation menu.

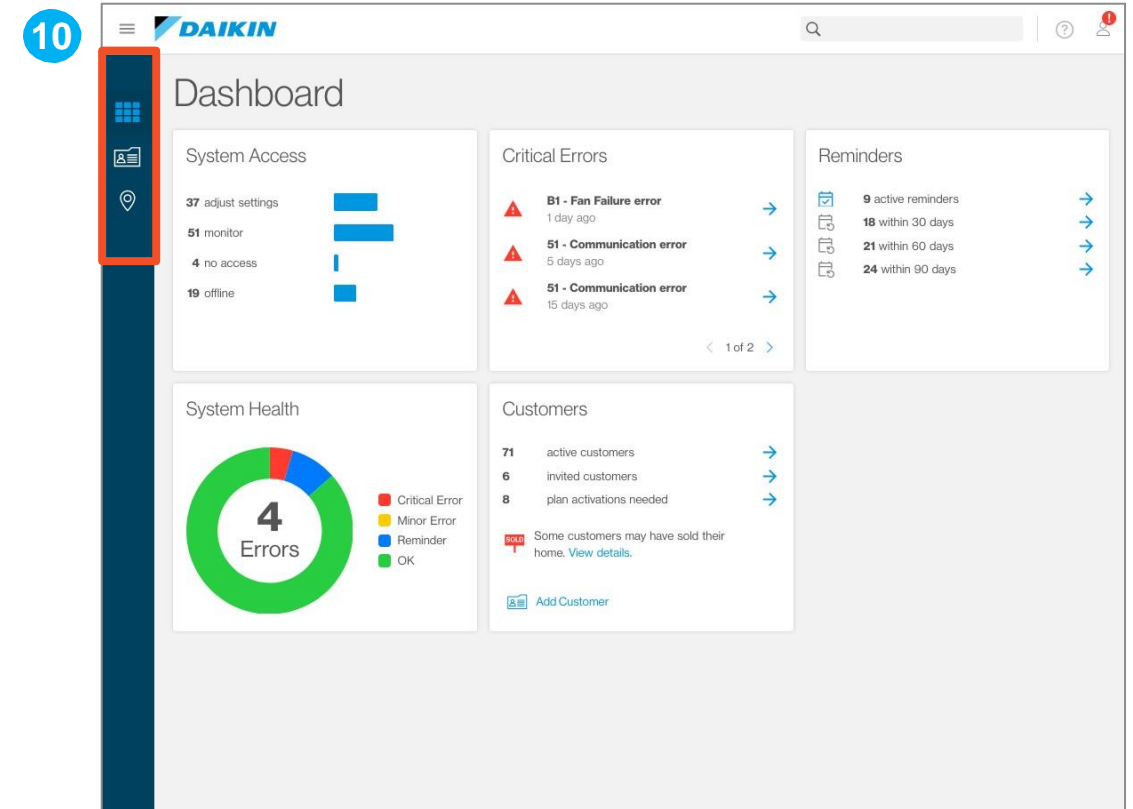
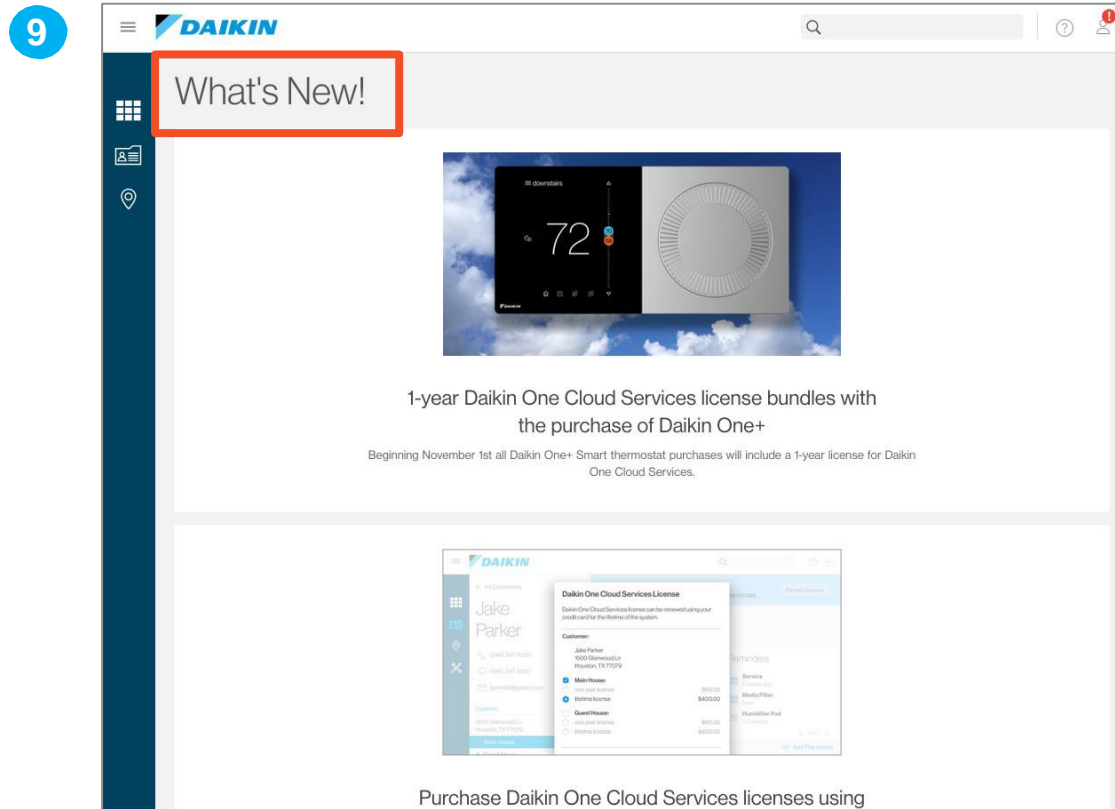

Agenda

Daikin *One* Lite

System Configurations

Installing Daikin *One* Lite

Daikin *One* Cloud Services

Commissioning Daikin *One* Lite

Daikin *One* Home

Creating System Profiles

- Download the Daikin *One* Cloud Services app. from your respective app. store.
 - Create an account.
 - Opening the app. and selecting the tools icon at the bottom of the screen will access the system profile creation process.
- System profiles enable the technician to modify settings from the app. and then upload those settings to the thermostat.
 - Must be a part of an organization to save profiles.

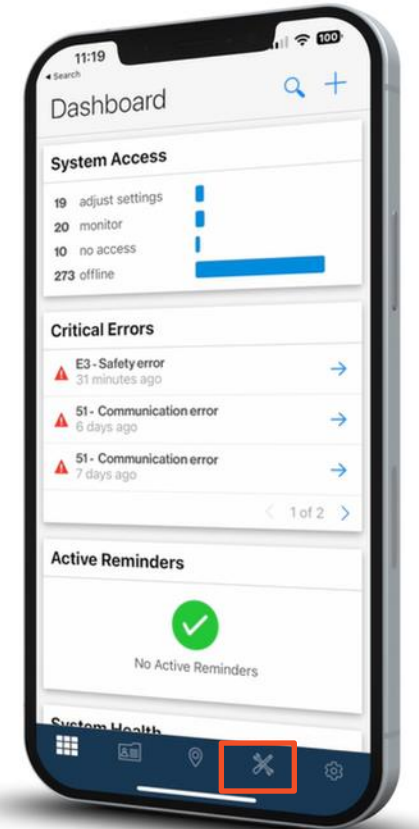

Create Profile

- Selecting “View Profiles” shows a list of all created profiles.
 - To create a new profile, select the plus.
 - Saving a newly created profile will allow it to appear on the system profile screen.

NOTE: If not a part of an organization, you will not have access to view or save profiles and will proceed through “Cloud Commissioning”.

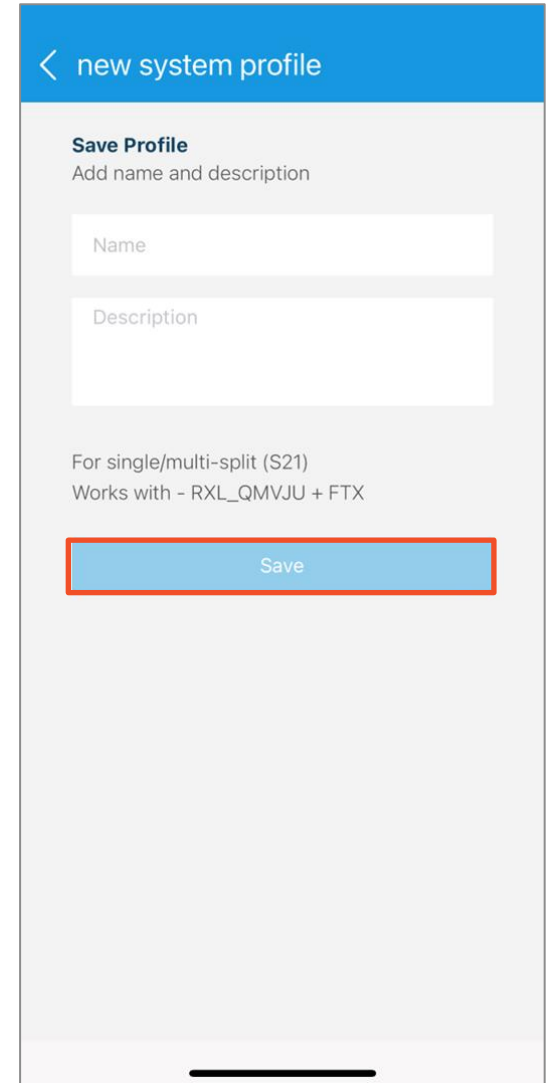
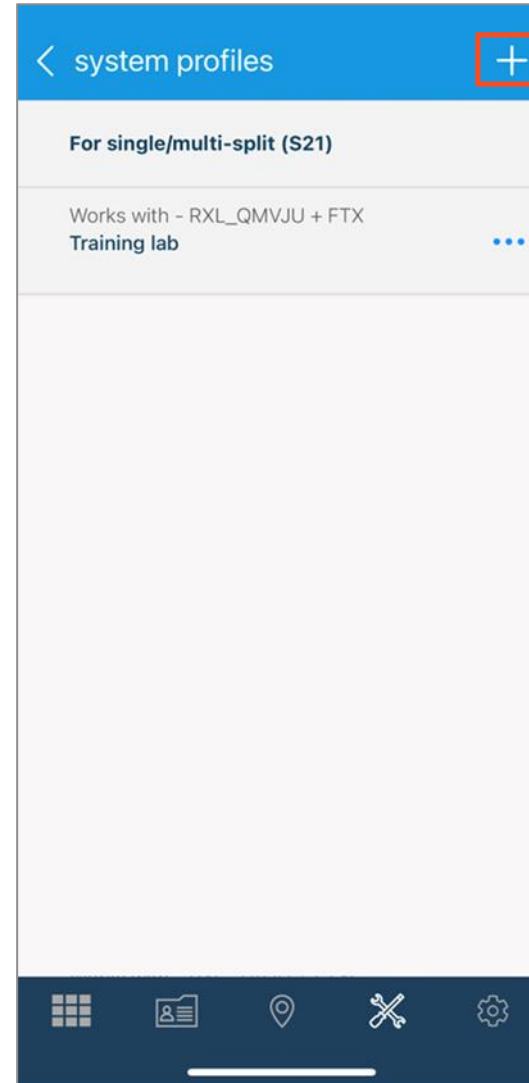
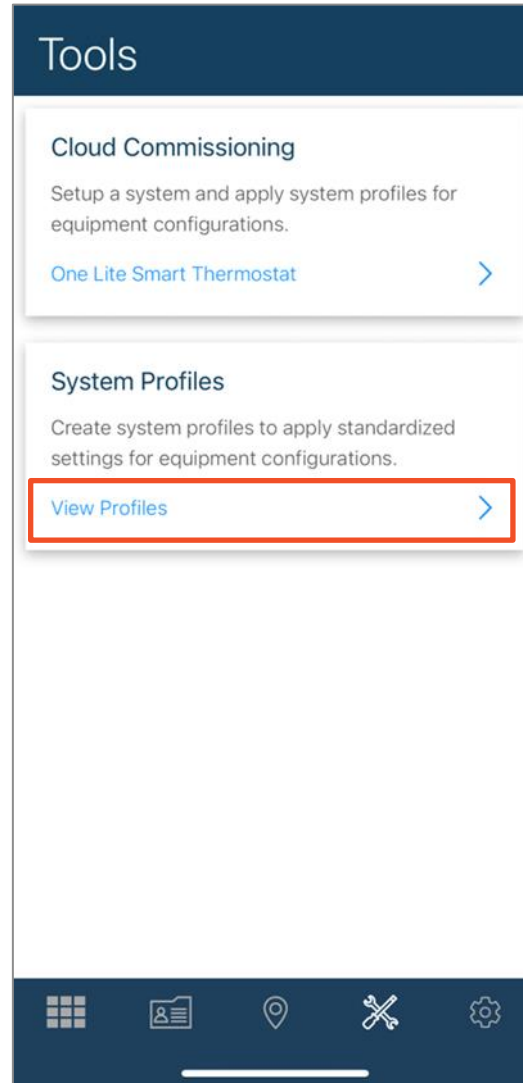

Setup Thermostat

- Selecting “One Lite Connected Thermostat” allows the installer to complete the following steps:
 - Connect to thermostat
 - Select equipment
 - Make adjustments
 - Upload system profile
 - Configure home Wi-Fi
 - Finish setup

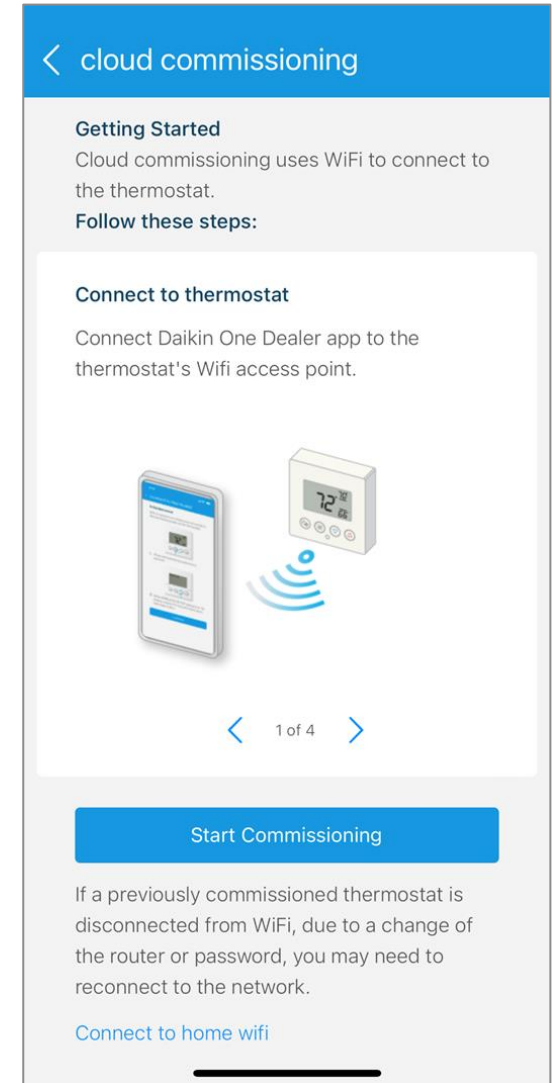
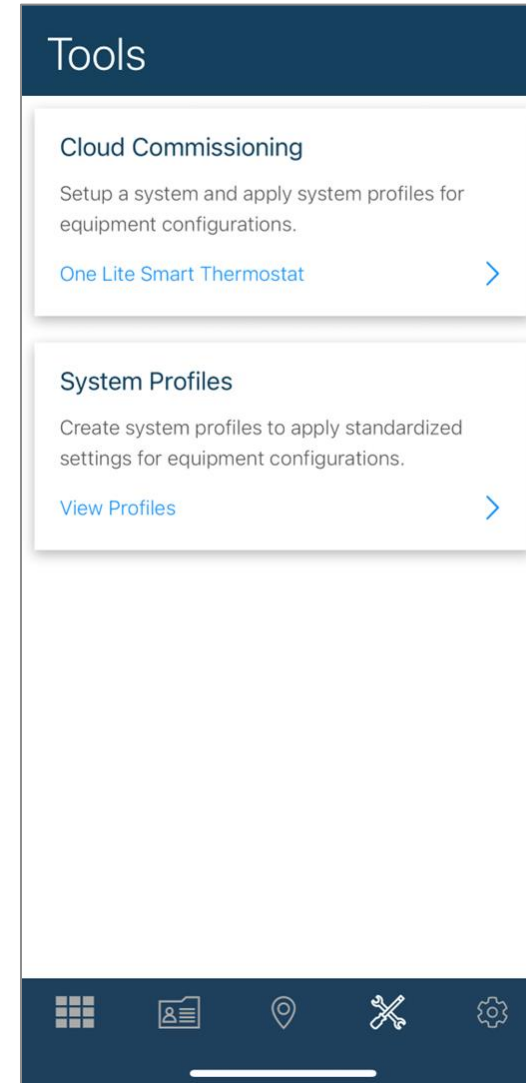

Connect App. to Thermostat Wi-Fi



- Press and hold the fan button for 5 seconds.
 - Release the fan button and press the down button to continue.
 - Approximately 10 seconds to enter AP mode.
- On your mobile device, tap “Discover Device”.
 - When connecting to the thermostat's access point, the mobile device **MUST** be within two feet.
 - Tap “Join” to pair the device with the thermostats network.

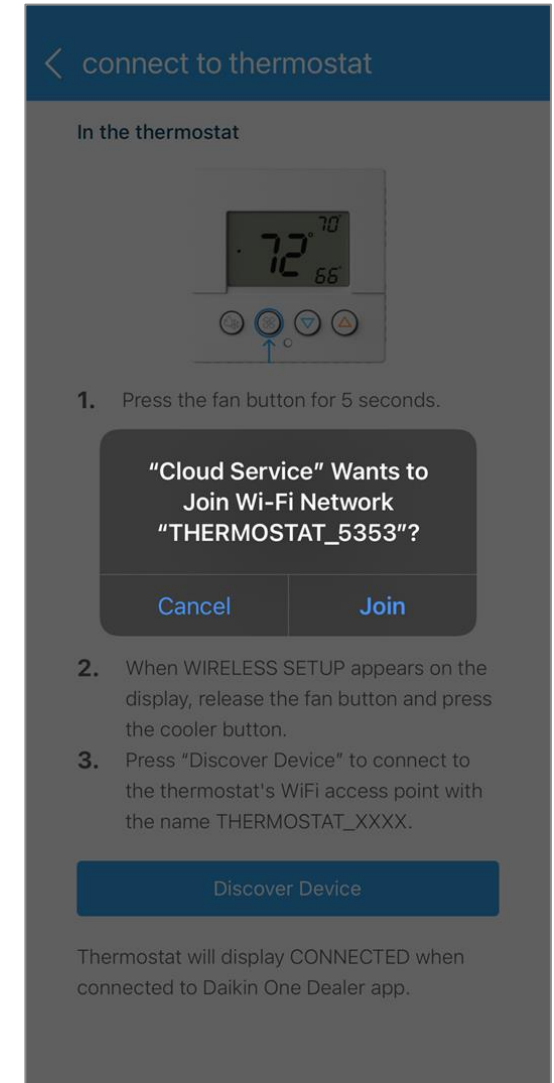
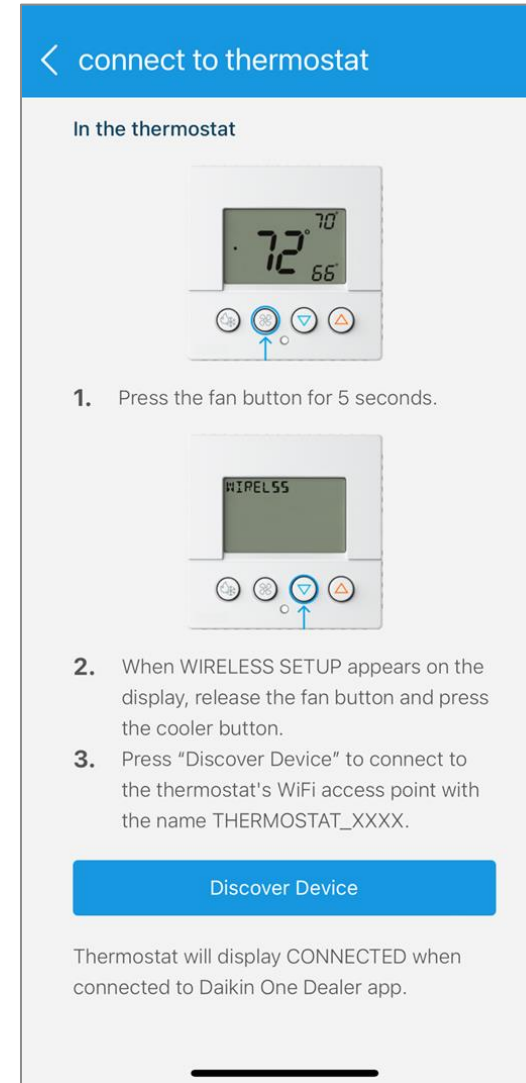

Selecting Equipment

- Connecting to the thermostat hotspot allows you select the outdoor and indoor units.

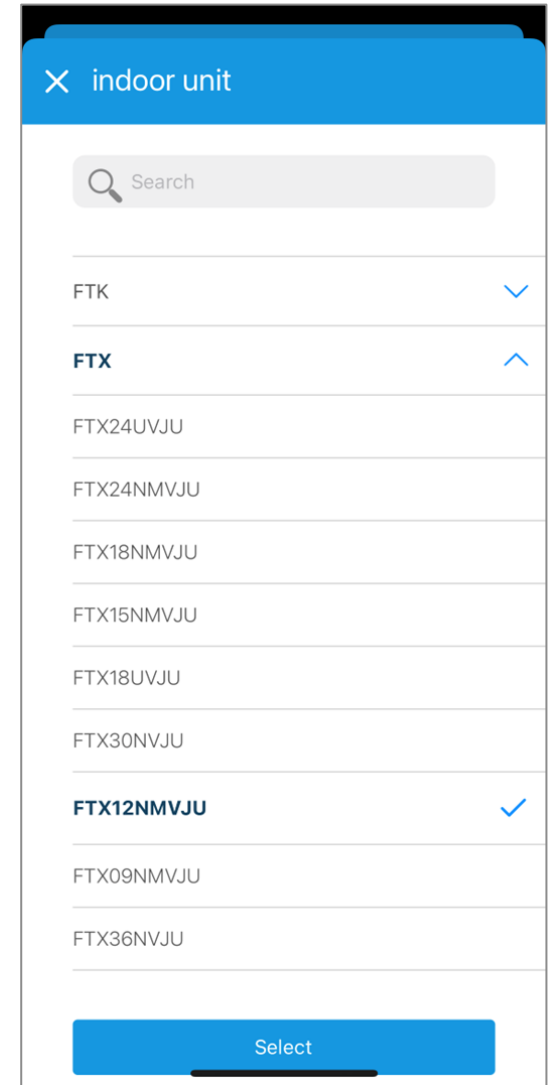
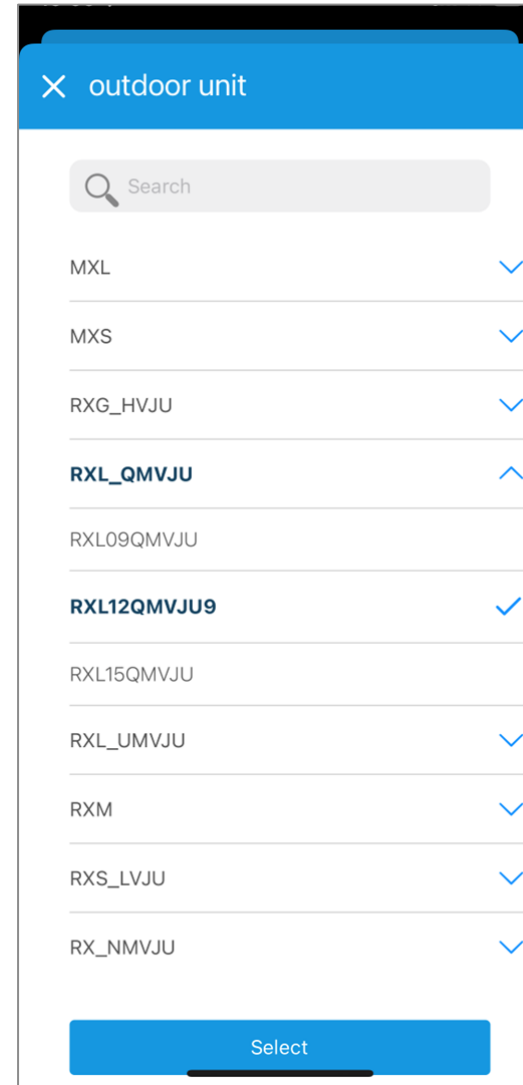
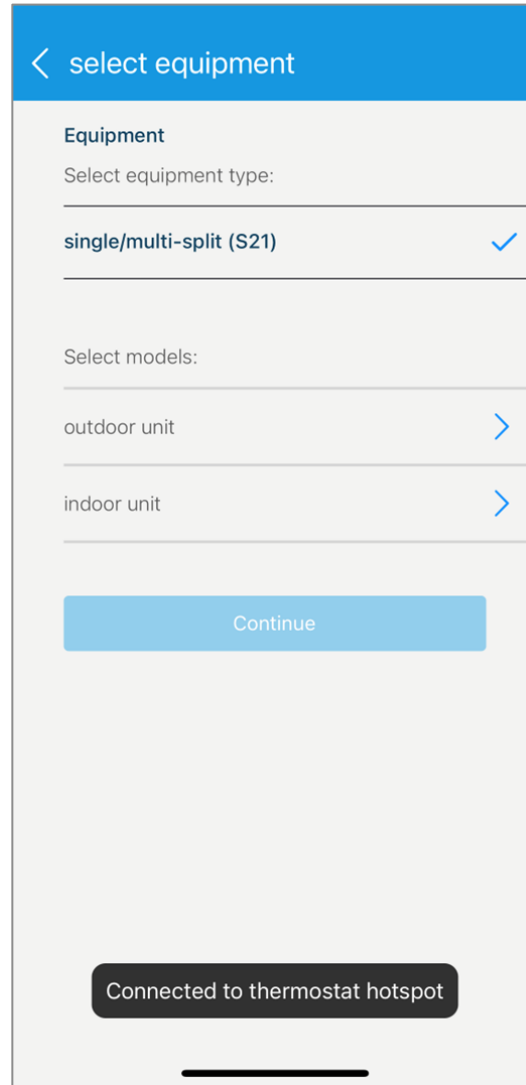

Applying System Profile



- Tap “Continue” once compatible units have been selected.
- If a part of an organization, created profiles will be listed.
 - You can select and or modify any profile to send to the thermostat.
- If not a part of an organization, “standard” will be the only profile option.

NOTE: Modifying the profile does not affect the saved profile.

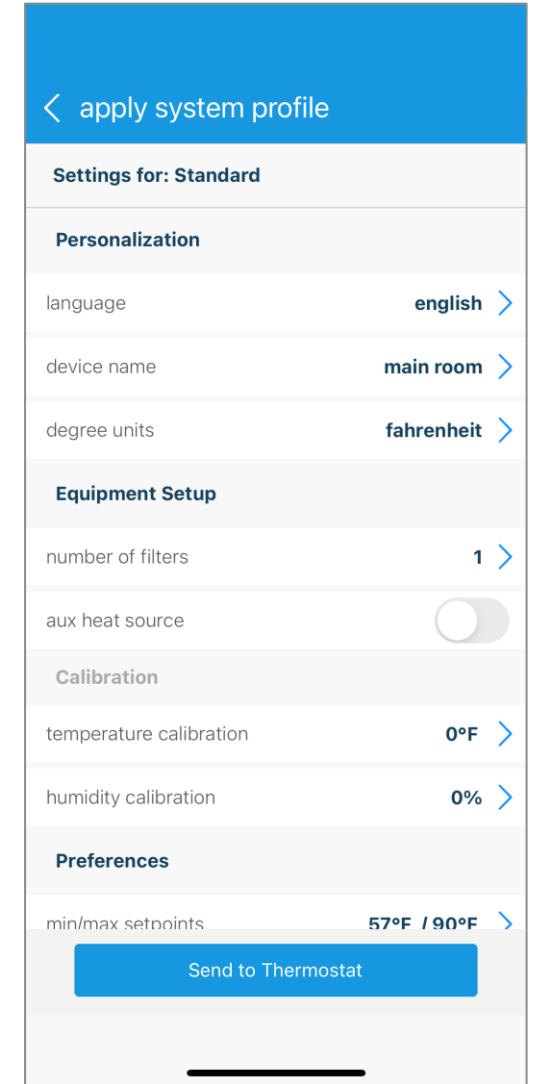
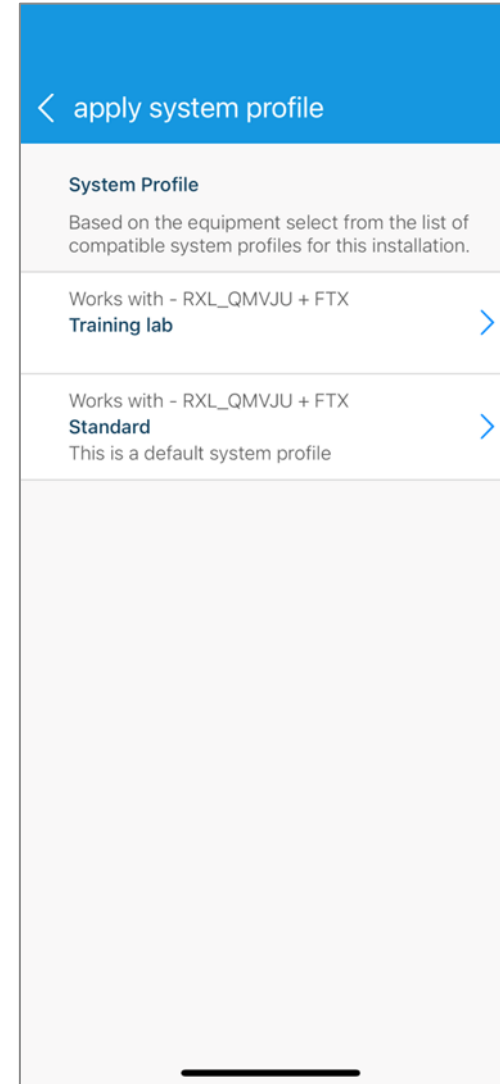
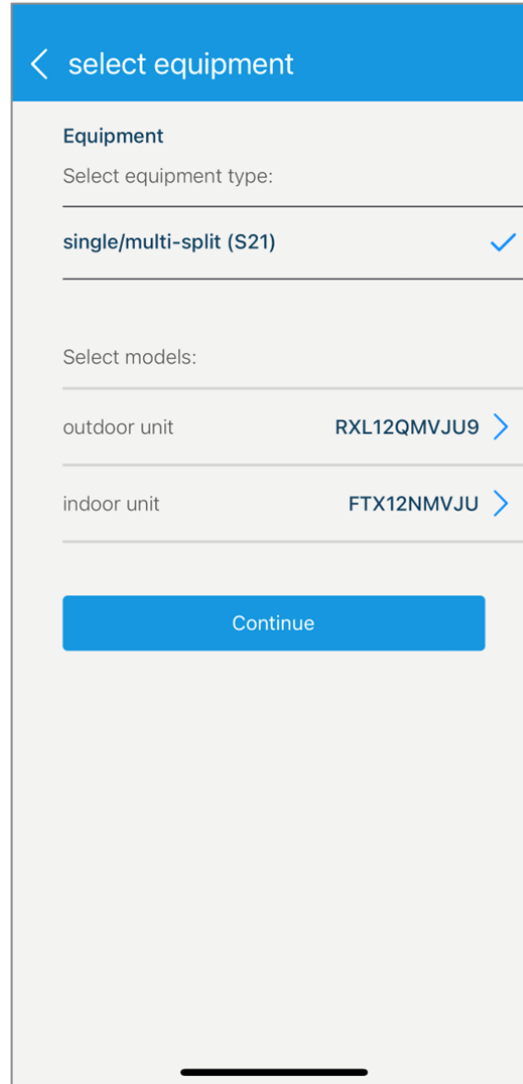

Connect to Wi-Fi

- Once the profile is sent to the thermostat, you will have the option to set up Wi-fi through the homeowners' network.

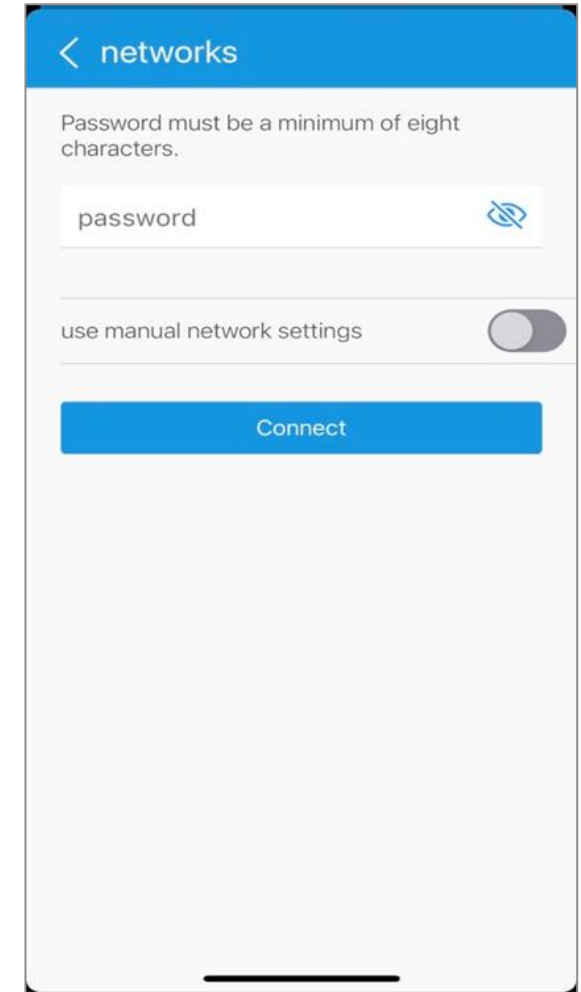
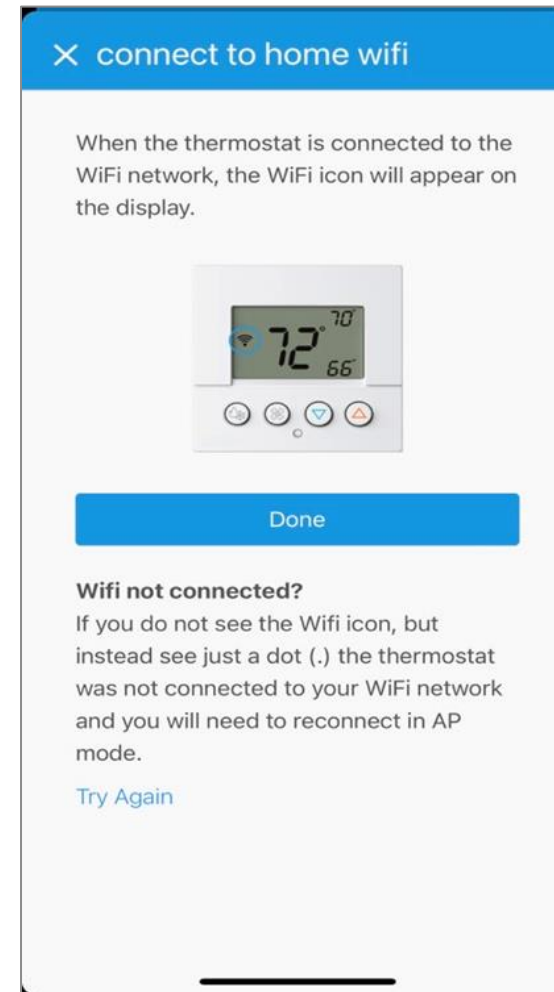
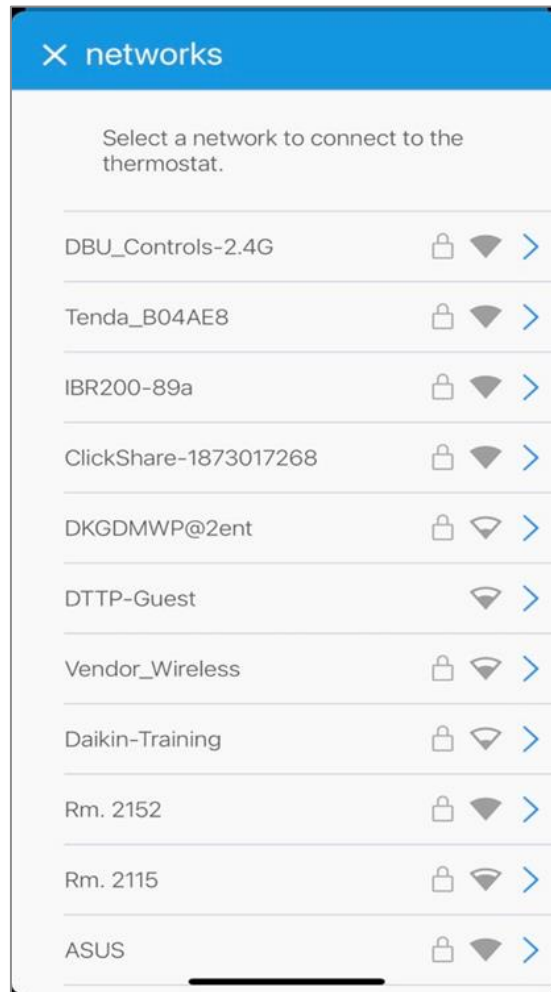
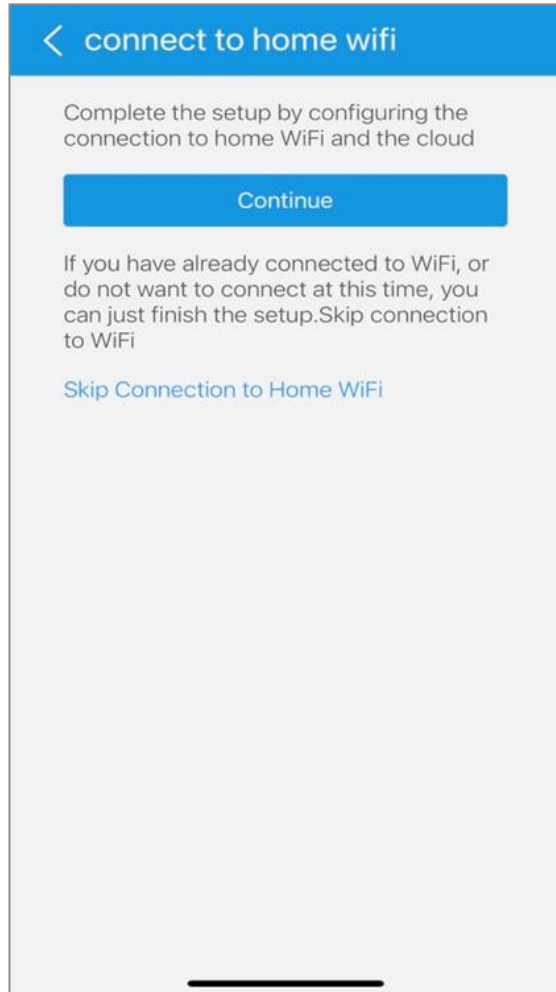

Agenda

Daikin *One* Lite

System Configurations

Installing Daikin *One* Lite

Daikin *One* Cloud Services

Commissioning Daikin *One* Lite

Daikin *One* Home App.



- Setting up an account is a four-step process.
 1. Downloading the application from your IOS or Android application store.
 - Creating the account.
 2. Confirming your account.
 3. Adding the thermostats' location.
 4. Connecting the app to the thermostat.

Note: A mobile device, the **Daikin One Lite** connected to **Wi-Fi** that is wired to an **S21 system** and a valid **email address** is needed to create a mobile account.

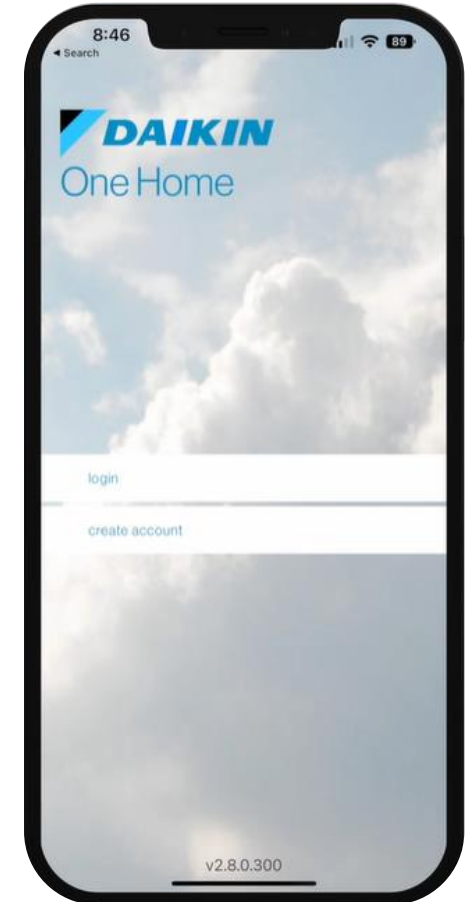
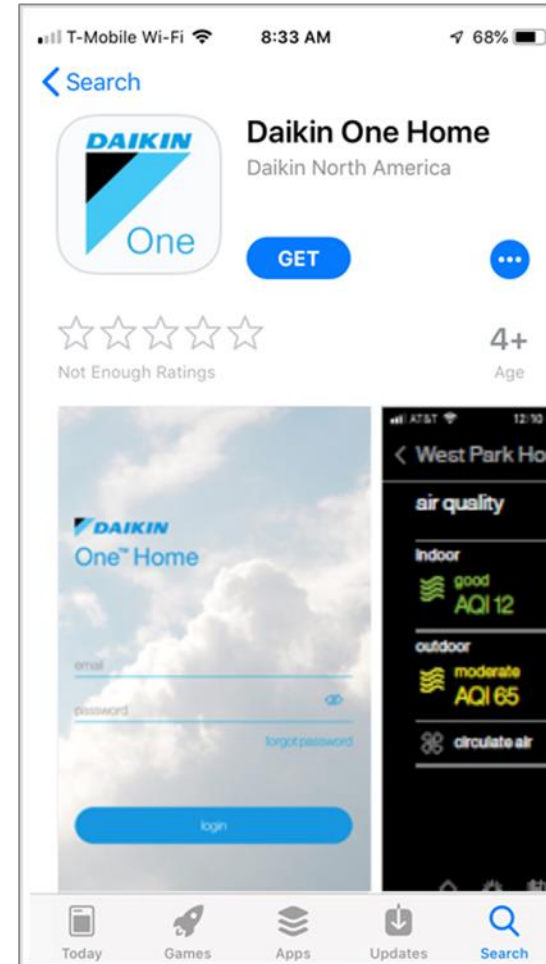

Step 1 - Create the Account

- Tapping **create account** at will start the process.
- **Before** agreeing, read the terms and service, privacy statement, and other notices.
- Fill in your name, valid email address, and password.

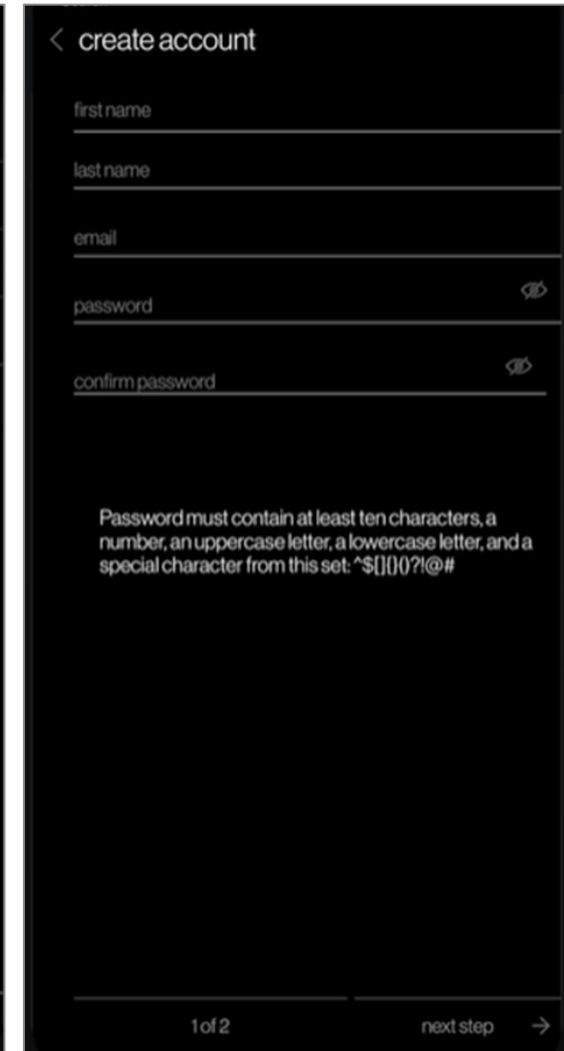
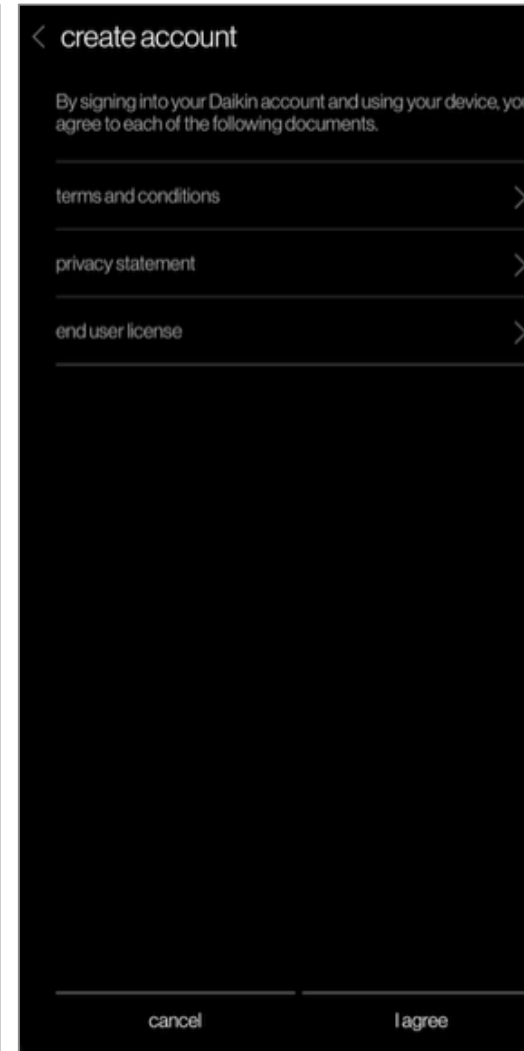
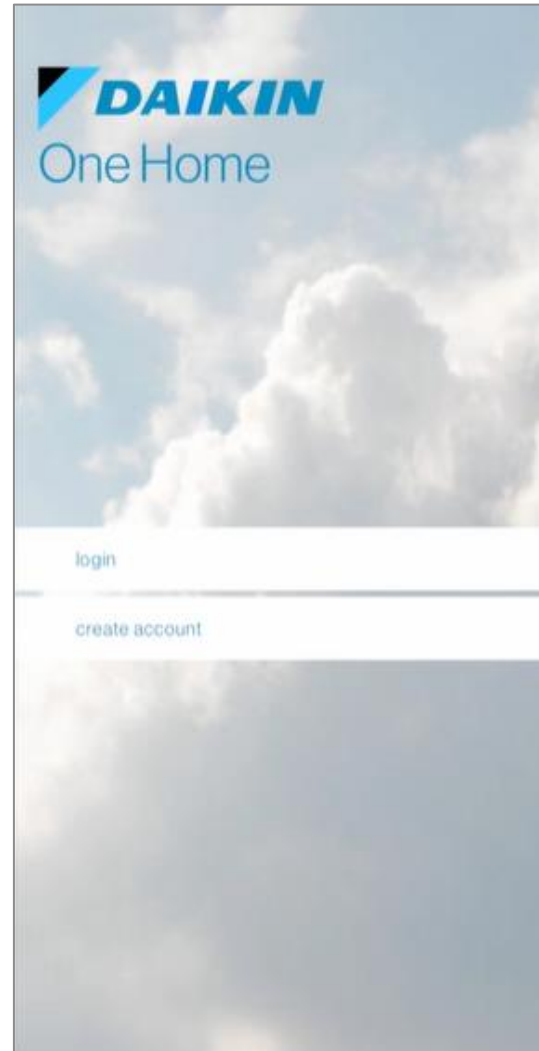

Step 2 - Confirming the Account

- You will be prompted to access the **email address** you provided when creating the account.
- A welcome email will appear in your inbox providing a **six-digit** code.
- Entering the six-digit code on your phone app. will allow you to continue.

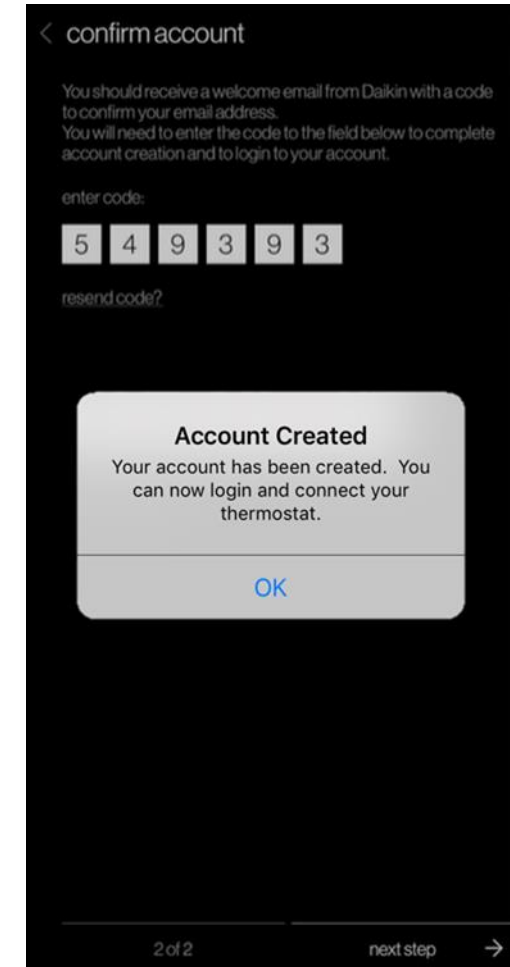
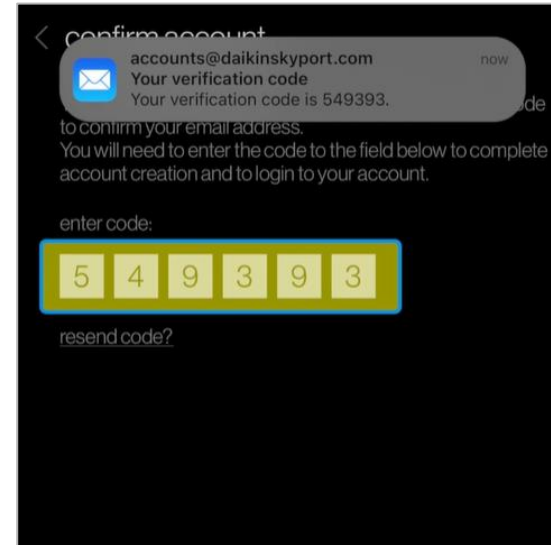

Step 3 - Adding the Thermostats Location

- Tap the login button and enter the email and password associated to your mobile account and.
 - If you have forgotten your password, tap the forgot password link to recover information via email.
- Type the address of where the thermostat is located to gather accurate information.

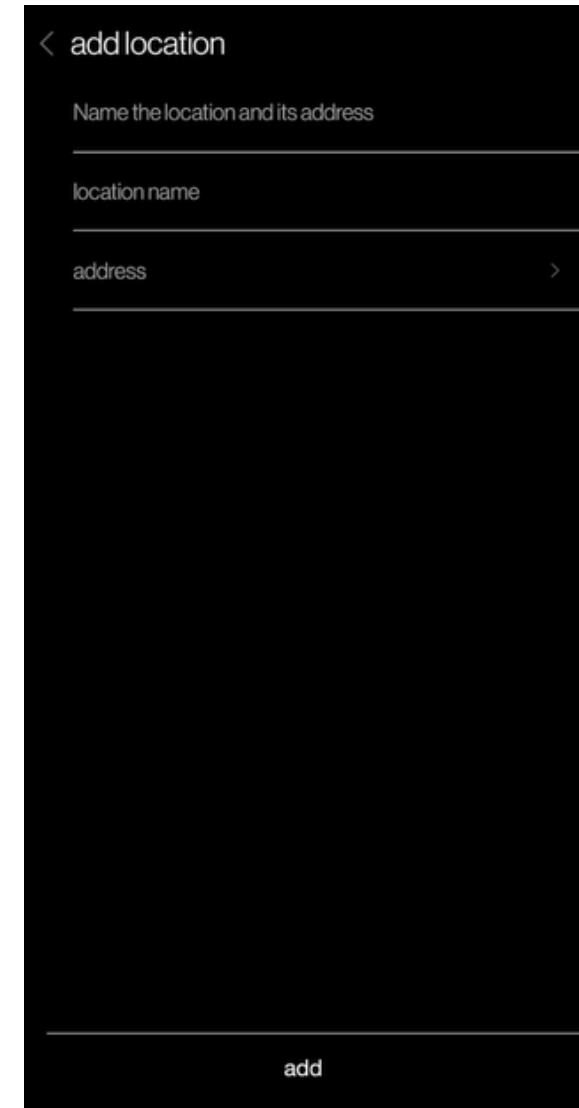
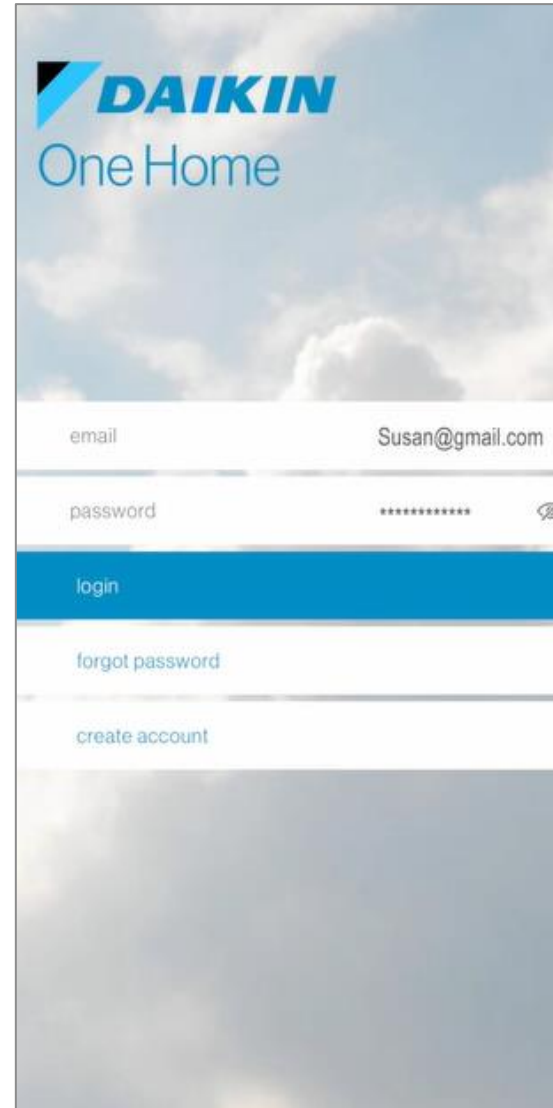

Step 4 - Connecting the App. to the Thermostat

- Tap the added location and select “add thermostat”.
- Once the thermostat has been selected in the app., press and hold the fan button until the words “wireless setup” appears.
 - Select next on the mobile app. after “wireless setup” appears.



Step 4 - Connecting the App. to the Thermostat (Cont.)



- On the thermostat, press the warmer button to reveal the six-digit code.
 - Select next on the mobile app. after code appears.

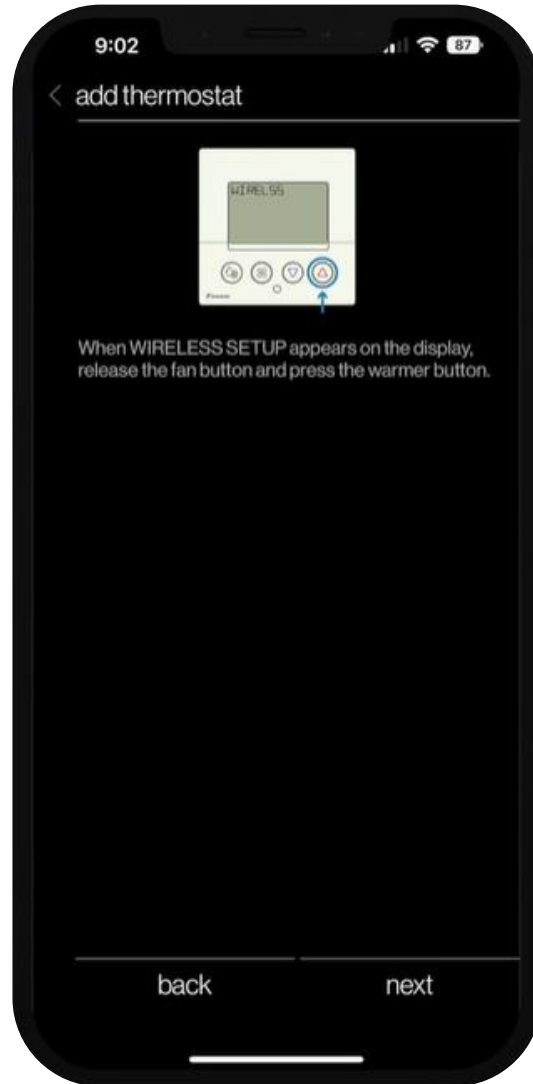

Step 4 - Connecting the App. to the Thermostat (Cont.)

- In the mobile app., enter the code displayed on the thermostat and select “add”.

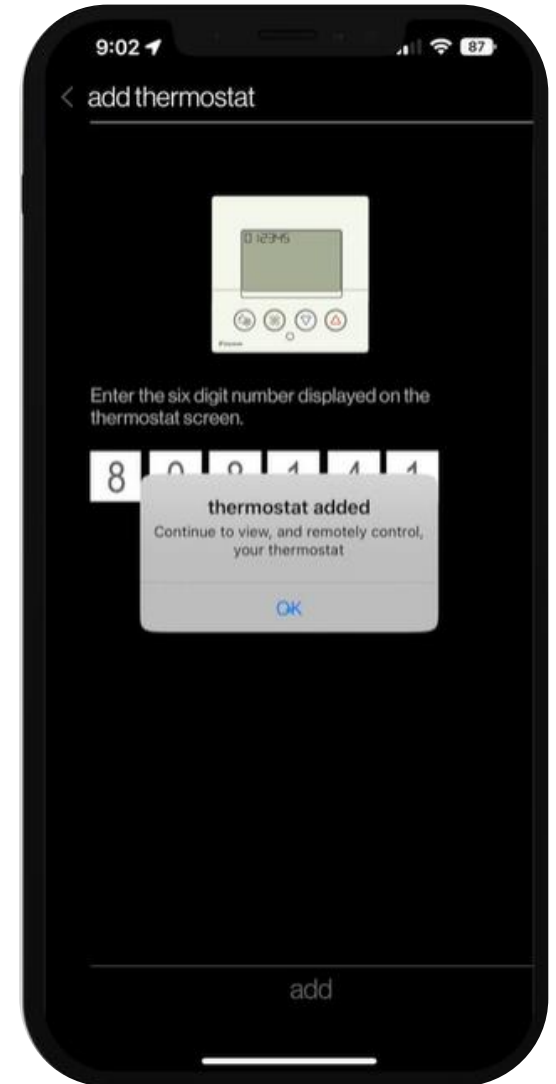
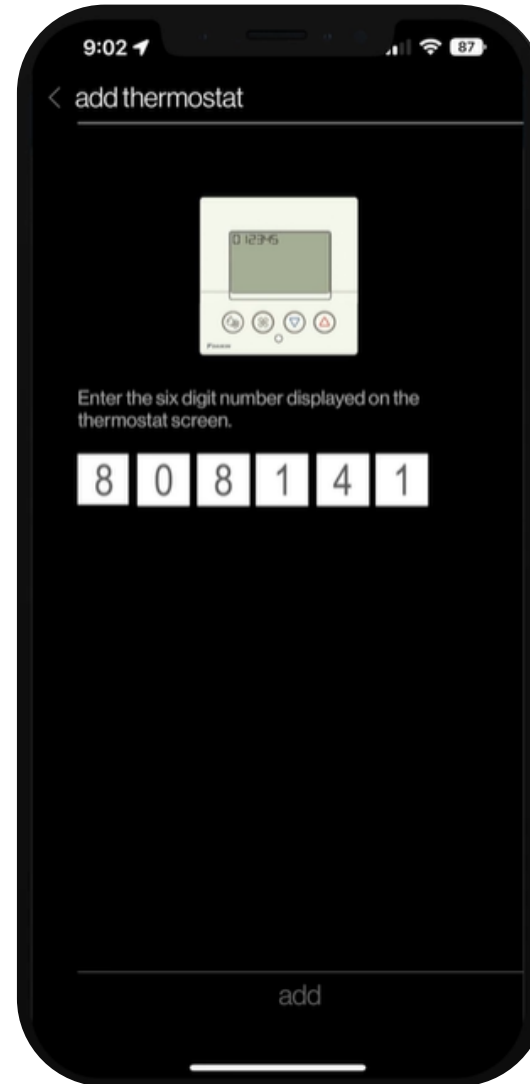

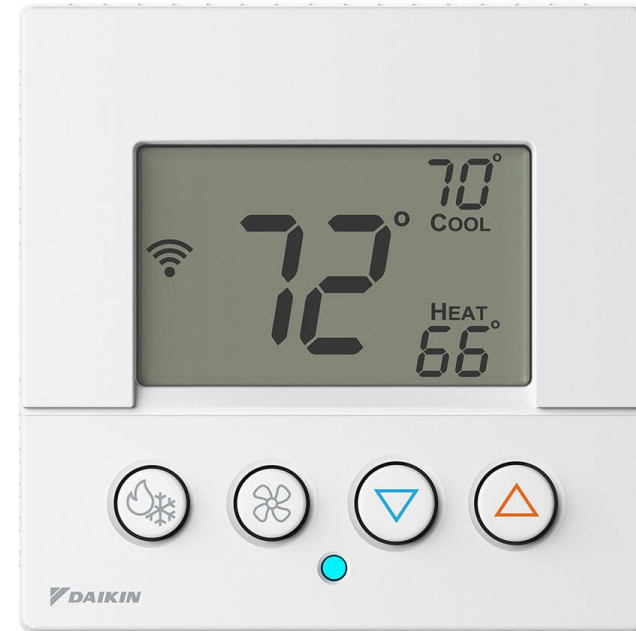
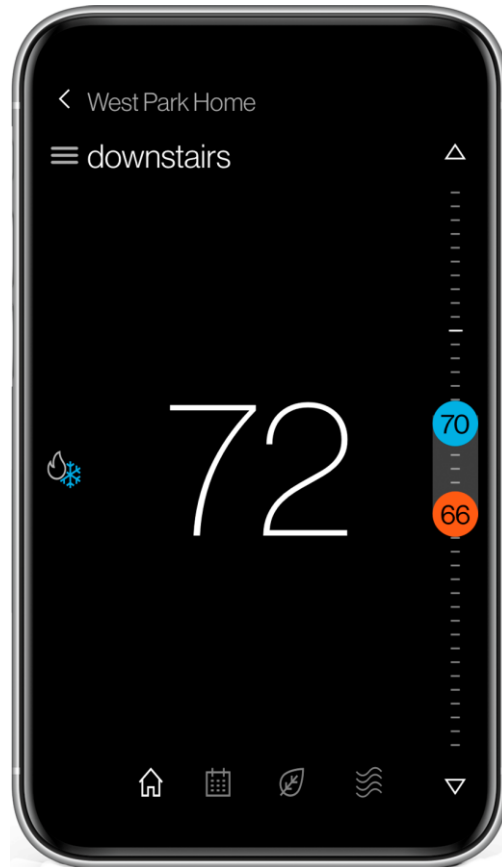

Visit [Daikinone.com](https://www.daikinone.com) for additional information

